

ROD 456

Synchro-flange

For external signal interpolation

100000 measuring steps/rev.

with 5000 lines after 5-fold interpolation

Standard line counts

48	50	60	100	120
125	128	150	180	200
250	254	256	300	360
375	400	420	500	512
600	625	635	720	800
900	1000	1024	1080	1125
1250	1270	1500	1750	1800
2000	2048	2080	2500	2540
2920	3000	3600	3750	4000
4096	4490	4500	5000	

Mechanical Data

Shaft speed	max. 12000 rpm	
Shaft load	axial	10 N
	radial	20 N (at shaft end)
Moment of inertia of rotor	1.45 · 10 ⁻⁶ kgm ²	
Weight	approx. 0.25 kg (0.55 lb)	
Operating temperature	-20 to 85° C (- 4 to 185° F)	
Storage temperature	-30 to 85° C (-22 to 185° F)	
Vibration (55 to 2000 Hz)	≤ 100 m/s ² (DIN IEC 68-2-6)	
Shock (6 ms)	≤ 1000 m/s ² (DIN IEC 68-2-27)	

Versions

Electrical connection

Protection (torque M_d)

ROD 456 .0000	Cable axial or radial	IP 64 (M _d ≤ 0.01 Nm)
ROD 456 .1000		IP 50 (M _d ≤ 1.5 · 10 ⁻³ Nm)

Dimensions

in mm/inches

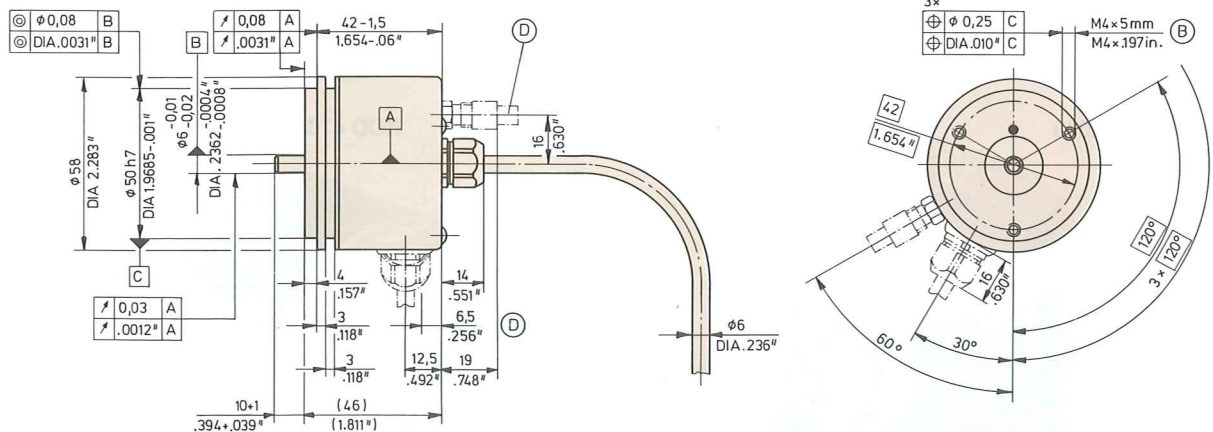

A Ball bearing

B Threaded mounting hole

D Compressed air inlet